

**FOR LEASE // 199 PICKETT DISTRICT RD, NEW MILFORD CT**



**PROPERTY DESCRIPTION**

Brand new storage units in Southern New Milford. Ideal for contractor, car/boat storage or light industrial uses. Sizes vary from 1,200 Ft - 4,800 Ft. Easy access to Route 7 and I84.

**PROPERTY HIGHLIGHTS**

- 10- 14 Ft Drive in Doors
- 100 amp, Single Phase Power
- Well and Septic
- LED Lighting
- 12 - 16' Ceilings
- Separately Metered for Propane Heat
- Handicap Bath for Each Unit

**OFFERING SUMMARY**

Lease Rate:	\$1,500 Per Month + Util
Unit	3
Available SF:	+/- 1,200

DEMOGRAPHICS	0.5 MILES	1 MILE	1.5 MILES
Total Households	274	982	2,038
Total Population	680	2,378	4,742
Average HH Income	\$87,123	\$96,027	\$98,611



**JOE DIMYAN**  
*Broker*  
 203.313.3920  
 jdimyan@towercorp.com



**MICK CONSALVO**  
*Broker*  
 203.241.5188  
 mconsalvo@towercorp.com

**FOR LEASE // 199 PICKETT DISTRICT RD, NEW MILFORD CT**

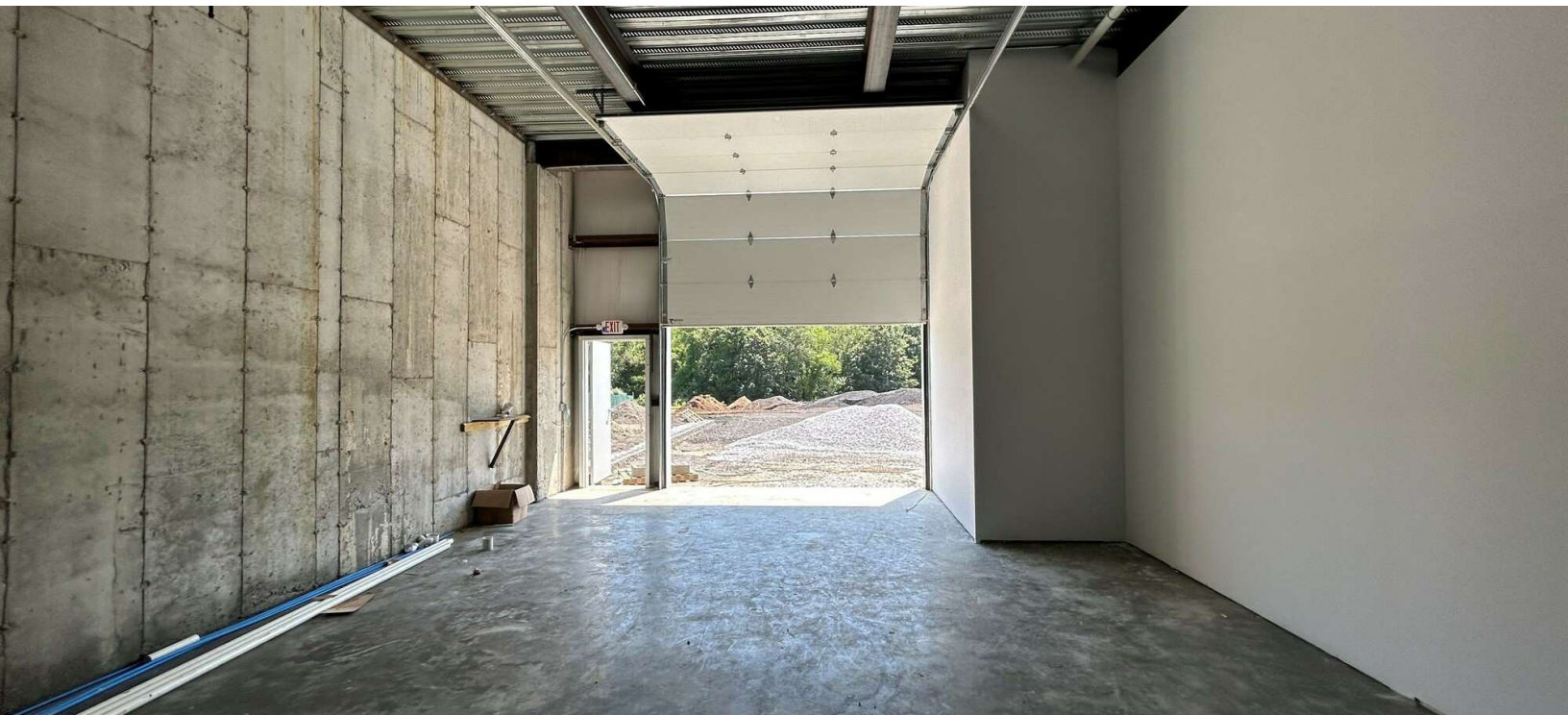

**JOE DIMYAN**

*Broker*

203.313.3920

[jdimyan@towercorp.com](mailto:jdimyan@towercorp.com)



**MICK CONSALVO**

*Broker*

203.241.5188

[mconsalvo@towercorp.com](mailto:mconsalvo@towercorp.com)

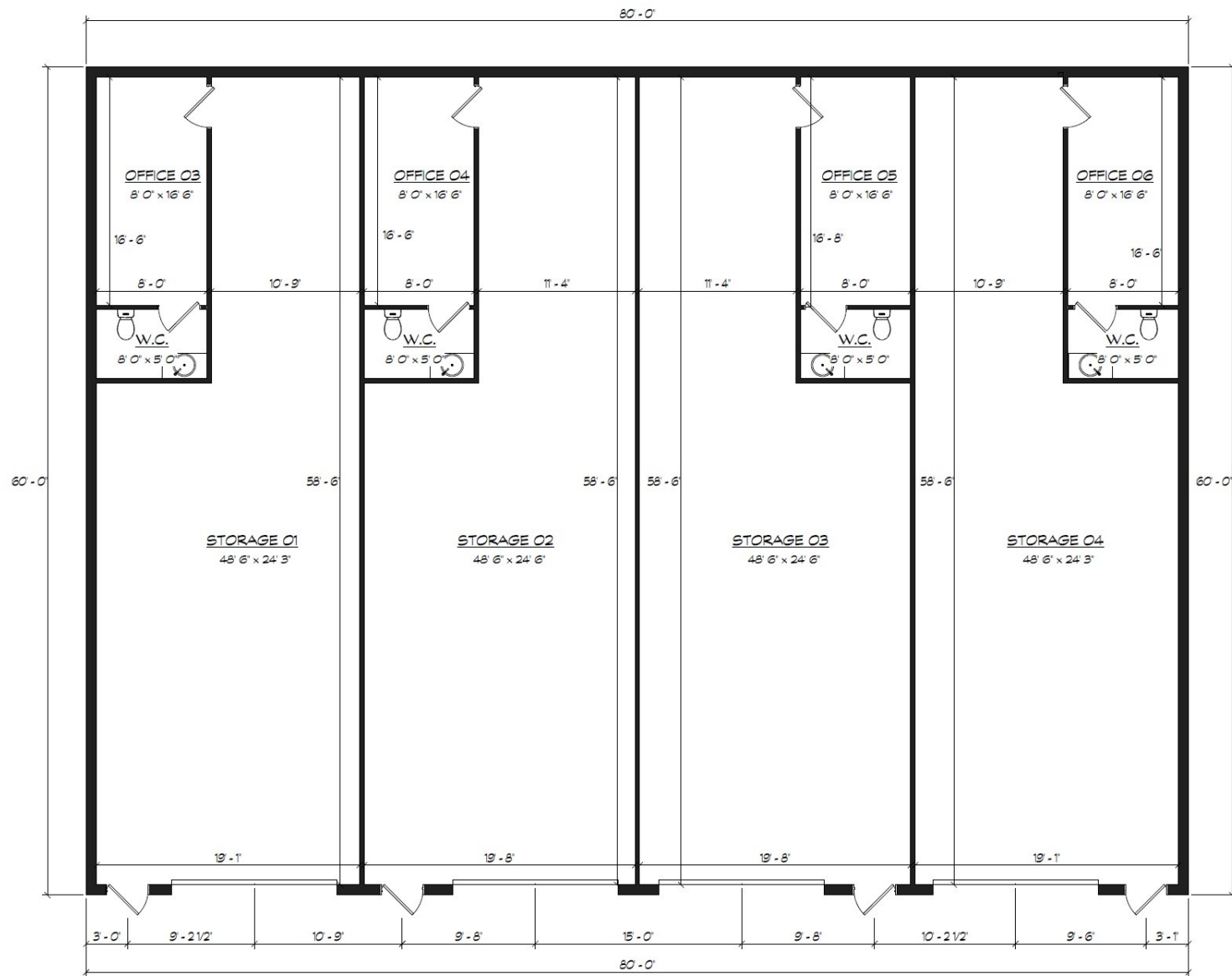

MAIN FLOOR AREA	
NAME	AREA

Office 03	132 sf
W.C.	55 sf
Storage 01	932 sf
Office 04	132 sf
W.C.	55 sf
Storage 02	966 sf
Office 05	132 sf
W.C.	55 sf
Storage 03	966 sf
Office 06	132 sf
W.C.	55 sf
Storage 04	934 sf

TOTAL FLOOR AREA	
4,800	sf

FLOOR PLAN  
PROGRESSIVE PRINT

DRAWN	
APPROVED	
DATE	
SCALE	
REVISIONS	

2 UPPER LEVEL

**SM01645 - Bruzzi Real Estate**

Rev Date: July 6th 2021

GRAPHIC SCALE:



Sheet No:

**A-103**

Sheet # of #

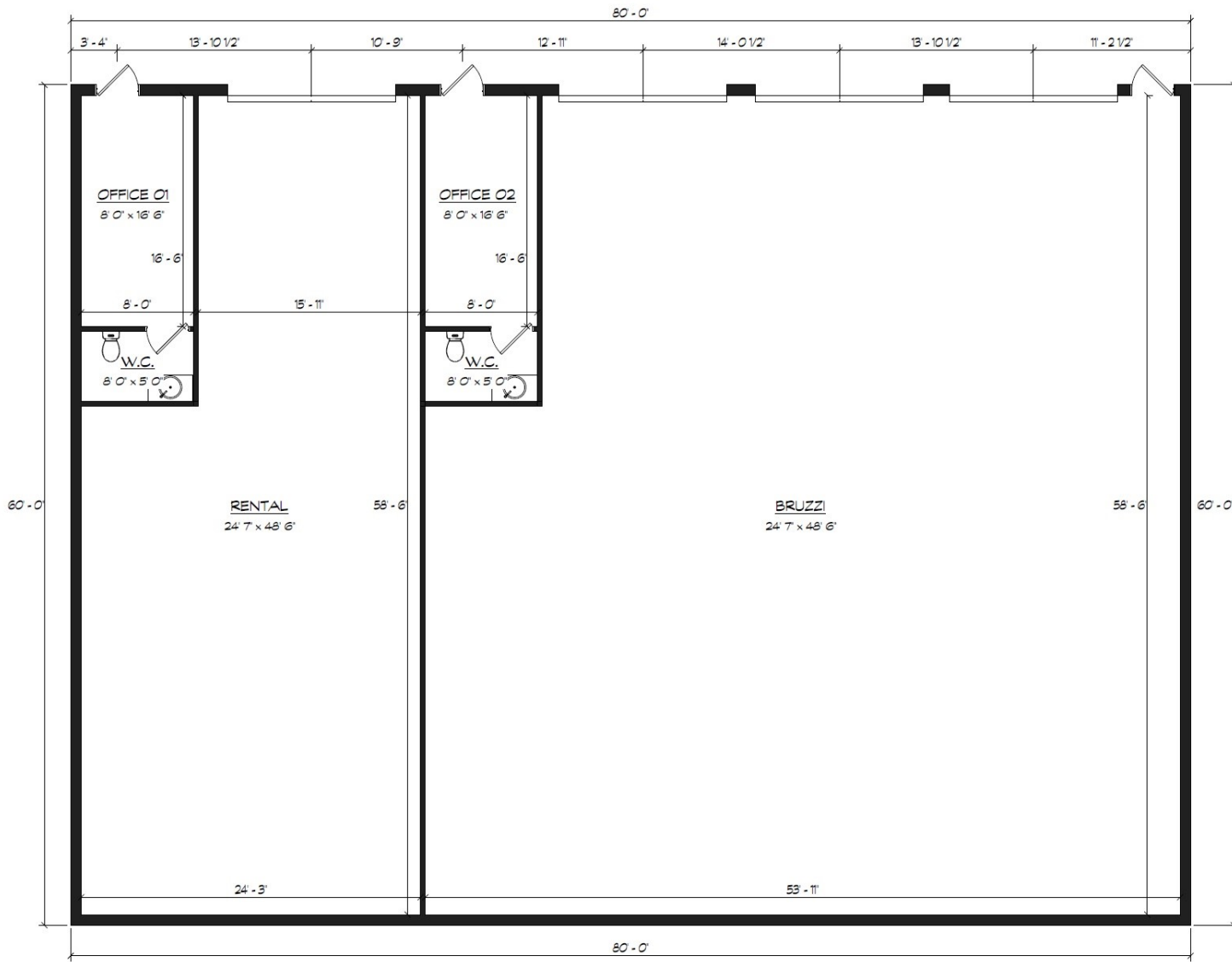

MAIN FLOOR AREA	
NAME	AREA

Office 01	132 sf
W.C.	40 sf
Rental	1234 sf
Office 02	132 sf
W.C.	40 sf
Bruzzi	2969 sf

TOTAL FLOOR AREA	
4,800	sf

FLOOR PLAN  
PROGRESSIVE PRINT

DRAWN	
APPROVED	
DATE	
SCALE	

REVISIONS

1 PRELIMINARY FLOOR PLAN

**SM01645 - Bruzzi Real Estate**

Rev Date: July 6th 2021

GRAPHIC SCALE:



Sheet No:

**A-102**

Sheet # of #

**FOR LEASE // 199 PICKETT DISTRICT RD, NEW MILFORD CT**

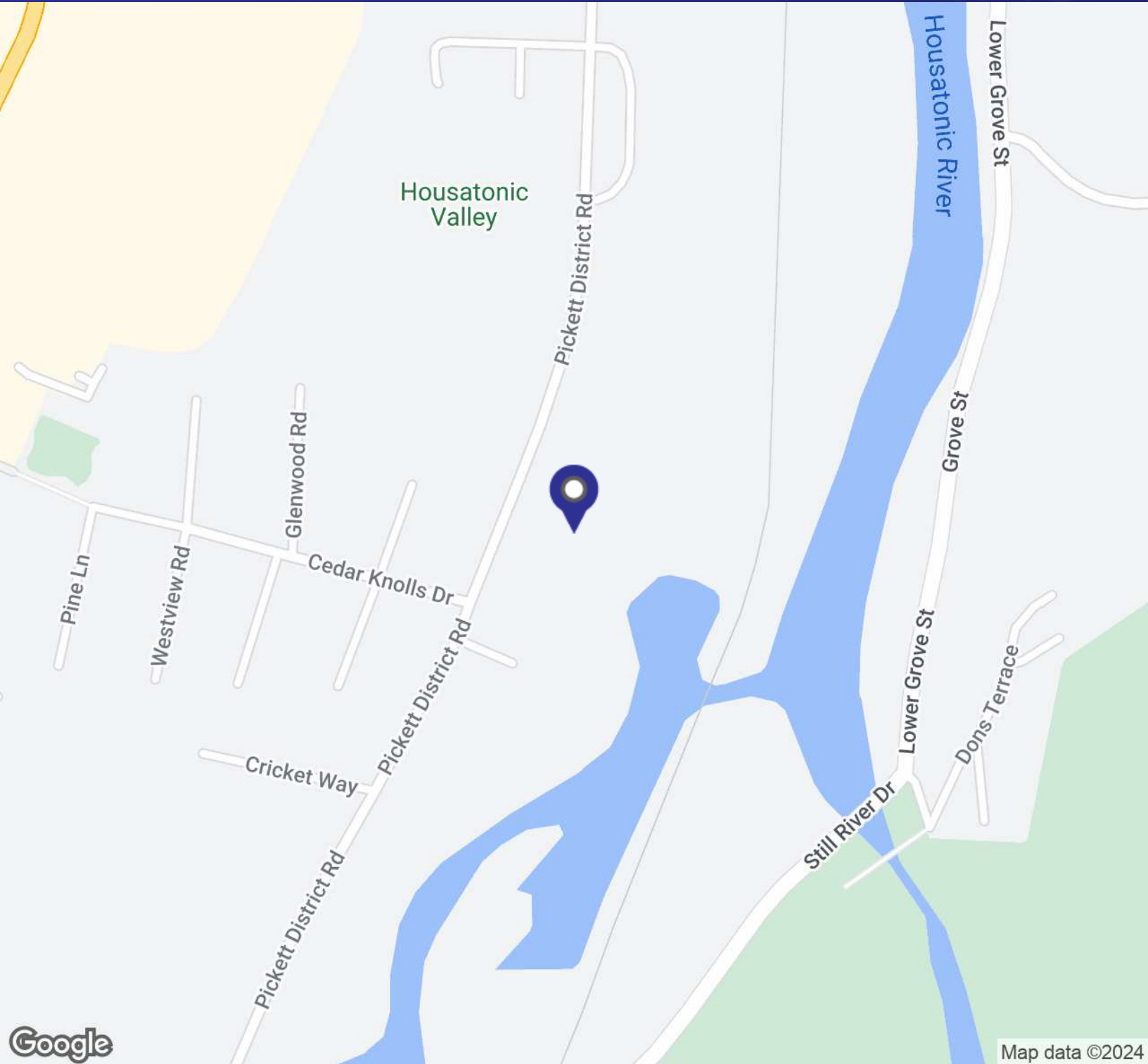

**JOE DIMYAN**

*Broker*  
203.313.3920  
jdimyan@towercorp.com



**MICK CONSALVO**

*Broker*  
203.241.5188  
mconsalvo@towercorp.com

**FOR LEASE // 199 PICKETT DISTRICT RD, NEW MILFORD CT**

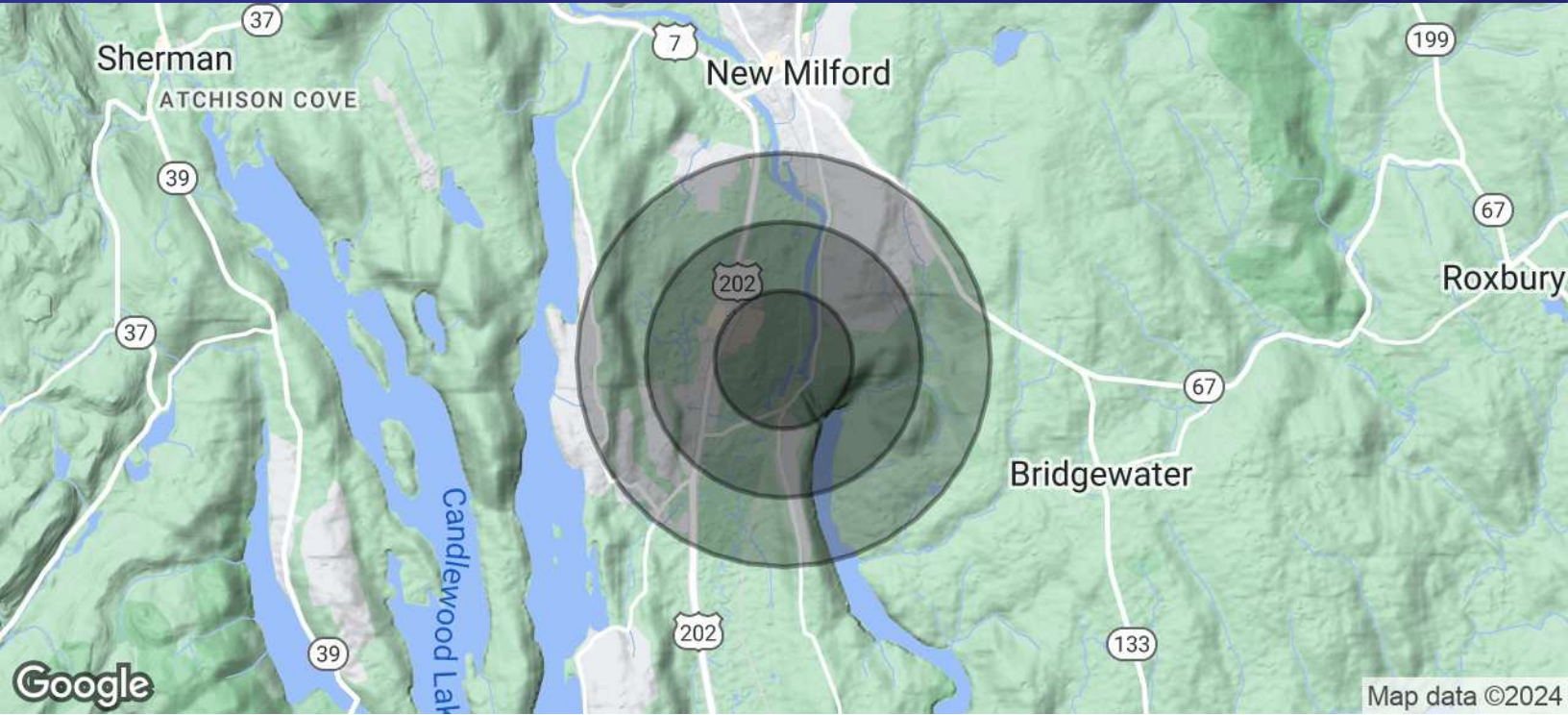

POPULATION	0.5 MILES	1 MILE	1.5 MILES
Total Population	680	2,378	4,742
Average Age	39.2	39.9	40.2
Average Age (Male)	33.1	36.6	37.8
Average Age (Female)	40.4	39.6	40.2

HOUSEHOLDS & INCOME	0.5 MILES	1 MILE	1.5 MILES
Total Households	274	982	2,038
# of Persons per HH	2.5	2.4	2.3
Average HH Income	\$87,123	\$96,027	\$98,611
Average House Value	\$250,224	\$263,312	\$273,053

2020 American Community Survey (ACS)



**JOE DIMYAN**

Broker  
203.313.3920  
jdimyan@towercorp.com



**MICK CONSALVO**

Broker  
203.241.5188  
mconsalvo@towercorp.com