

~ FOR LEASE ~

**PROFESIONAL OFFICE SUITES**



**30 Bridge Street,  
New Milford, CT**

This is a truly special building in a truly special location. Referred to as the *Gateway to New Milford*, this historic red brick building was completely renovated. It is ADA compliant throughout. It has a state of the art sprinkler system, a compliant fire alarm system; beautifully paneled elevator; artistically tiled lobby entrance; and plenty of its own parking. All units have separate HVAC and Filter system.

The building combines the best of the old with the best of the new... making this a truly special place for any tenant to call "home".



Building Size:	+/- 23,000 Sq. Ft. (With Annex)
Available Unit:	
Unit 104	+/- 780 Sq. Ft. \$1,100 + Utilities Reception area, 2 Private Offices
Unit 304:	+/- 592 Sq. Ft. \$675 + Utilities Reception area, Private office, Open Area and Private Outside Deck.
Elevator:	Yes; ADA Compliant
Zone:	B-2 (Commercial)
Utilities:	City Water; Sewer
Heating/Cooling:	Each Unit Has Separate Util. and HVAC System
Parking:	52 Spaces 172 Public Spaces at Railroad Station



**Mick Consalvo**  
203.241-5188  
mconsalvo@towercorp.com



**Joe Dimyan**  
203.313-3920  
jdimyan@towercorp.com

Tower Realty Corp. / 246 Federal Rd., Suite D26, Brookfield, CT 06804 / [www.towercorp.com](http://www.towercorp.com)  
203-775-5000 Office / 203-546-7793 Fax

No warranty of representation, expressed or implied is made as to the accuracy of the information contained herein, and same is submitted subject to errors, omissions, change of price, rental, sale or other conditions, withdrawal without notice, and to any special listing conditions imposed by our principals.

~ 1st FLOOR FLOORPLAN ~

30 BRIDGE STREET, Unit 104  
NEW MILFORD, CT

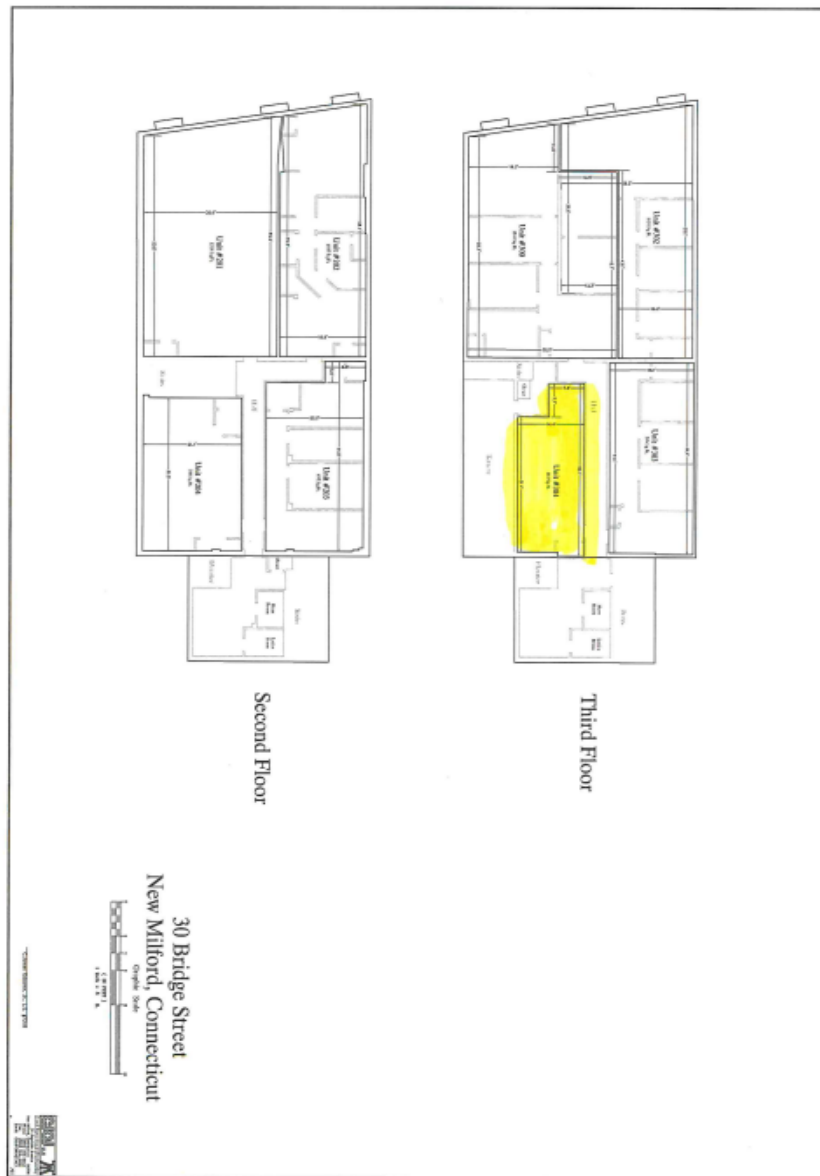

**Mick Consalvo**  
203.241-5188  
mconsalvo@towercorp.com



**Joe Dimyan**  
203.313-3920  
jdimyan@towercorp.com

~ 1st FLOOR FLOORPLAN ~

30 BRIDGE STREET, Unit 304  
NEW MILFORD, CT



TOWER REALTY CORP.

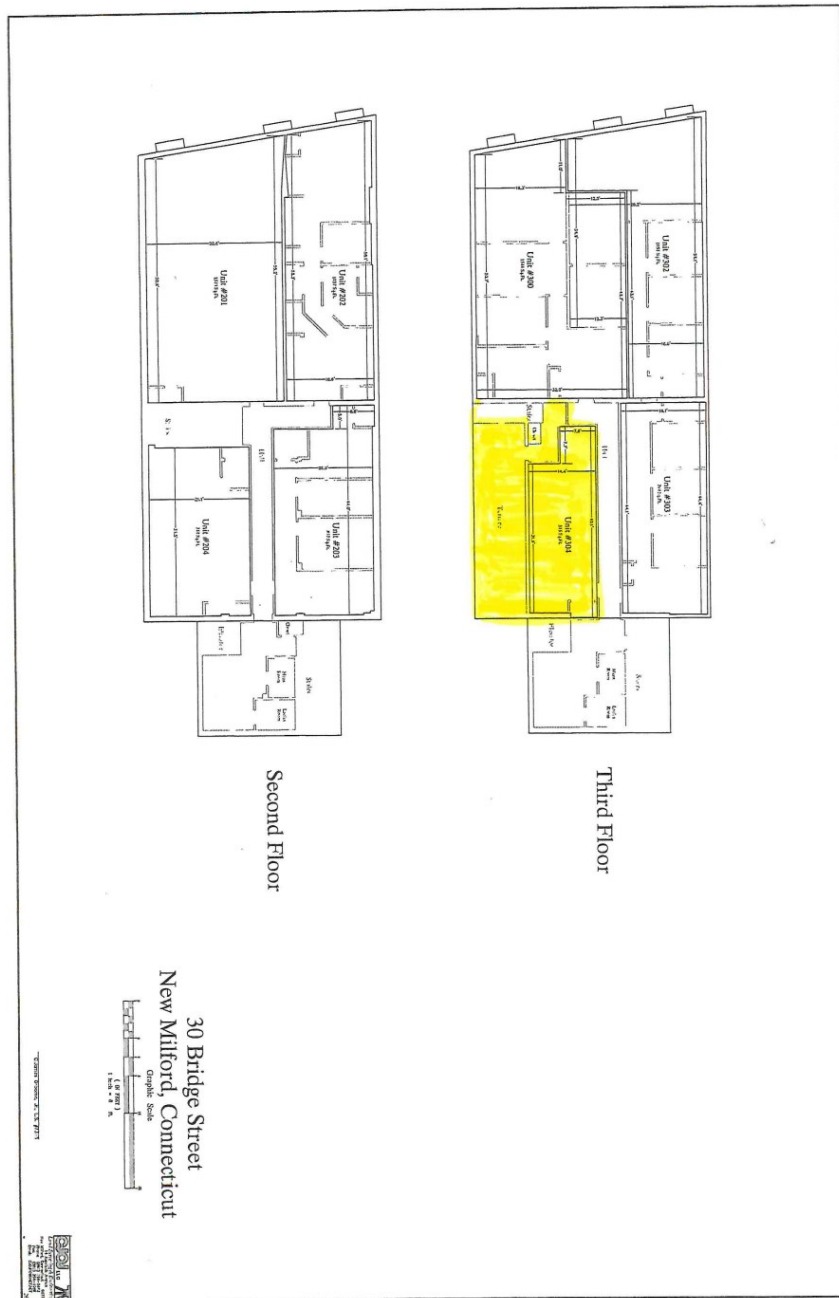

**Mick Consalvo**  
203.241-5188  
mconsalvo@towercorp.com



**Joe Dimyan**  
203.313-3920  
jdimyan@towercorp.com

Tower Realty Corp. / 246 Federal Rd., Suite D26, Brookfield, CT 06804 / [www.towercorp.com](http://www.towercorp.com)  
203-775-5000 Office / 203-546-7793 Fax

*~ ADDITIONAL PHOTOS ~*

30 BRIDGE STREET,  
NEW MILFORD, CT

**TRC**  
TOWER REALTY CORP.

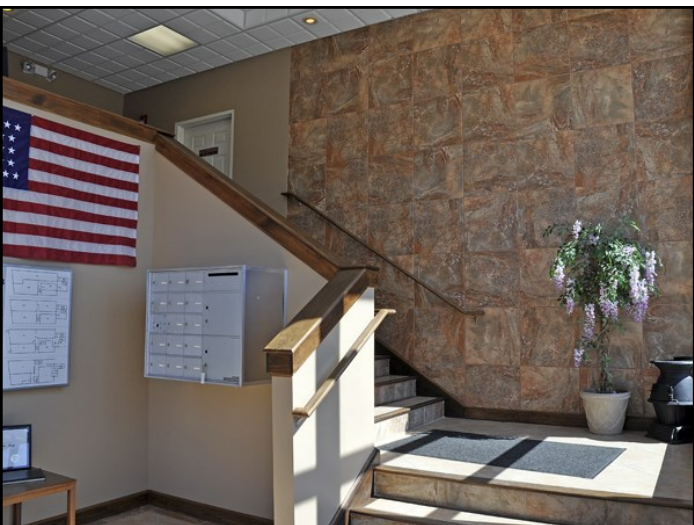

**Mick Consalvo**  
203.241-5188  
mconsalvo@towercorp.com



**Joe Dimyan**  
203.313-3920  
jdimyan@towercorp.com

Tower Realty Corp. / 246 Federal Rd., Suite D26, Brookfield, CT 06804 / [www.towercorp.com](http://www.towercorp.com)  
203-775-5000 Office / 203-546-7793 Fax

*~ ADDITIONAL PHOTOS ~*

30 BRIDGE STREET, Unit 304  
NEW MILFORD, CT



**Mick Consalvo**  
203.241-5188  
mconsalvo@towercorp.com



**Joe Dimyan**  
203.313-3920  
jdimyan@towercorp.com

Tower Realty Corp. / 246 Federal Rd., Suite D26, Brookfield, CT 06804 / [www.towercorp.com](http://www.towercorp.com)  
203-775-5000 Office / 203-546-7793 Fax

*~ LOCATION MAP ~*

30 BRIDGE STREET,  
NEW MILFORD, CT

**TRC**  
TOWER REALTY CORP.



**Mick Consalvo**  
203.241-5188  
mconsalvo@towercorp.com



**Joe Dimyan**  
203.313-3920  
jdimyan@towercorp.com

Tower Realty Corp. / 246 Federal Rd., Suite D26, Brookfield, CT 06804 / [www.towercorp.com](http://www.towercorp.com)  
203-775-5000 Office / 203-546-7793 Fax