

# TOWER REALTY CORP.



SPECIALISTS IN COMMERCIAL AND INDUSTRIAL REAL ESTATE

**~ FOR LEASE ~  
OFFICE SPACE**



## Available Units:

**Unit 102:** +/- 1,043 Sq. Ft. - Reception and Two Offices

**Unit 110/112** +/- 4,873 Sq. Ft. - Large Bull Pen and Four Private offices.

**Unit 210:** +/- 1,137 Sq. Ft. Open Floor Plan

**Zone:** HRF2 (Commercial )

**Utilities:** City Water; Sewer

**Heating:** Gas Heat

**Cooling:** Central A/C

**Parking:** 5 Spaces for Every 1,000 Sq. Ft.

**Elevator:** Yes

**Boat Slip:** Free with long term lease.

## Lease Prices:

**Unit 102:** \$1,200 + Utilities

**Unit 110/112:** \$10.00 NNN

**Unit 210:** \$1,000 + Utilities



Historic, fully restored 130,000 SF Historic Mill Building, 1/2 mile south of New Milford town green on the banks of the Housatonic inlet by Lake Lillinonah. Convenient to Routes 7, 202, and 67. Building has 12' operating windows, wood planked floors, natural brick interiors, is internet (cable) ready, fiber optic T1 on site and much more. Must see to fully appreciate. Units may be combined for larger suites. Landlord offering rent concessions and build out!



**Mick Consalvo**

203.241-5188

mconsalvo@towercorp.com

Tower Realty Corp. / 246 Federal Rd., Suite D26, Brookfield, CT 06804 / [www.towercorp.com](http://www.towercorp.com)  
203-775-5000 Office / 203-546-7793 Fax

~ FLOOR PLAN ~

30 Shelter Rock Road, Unit 3,  
Danbury, CT



TOWER REALTY CORP.

# The Bleachery

## 143 West Street, New Milford First Floor Vacancy

Not to Scale

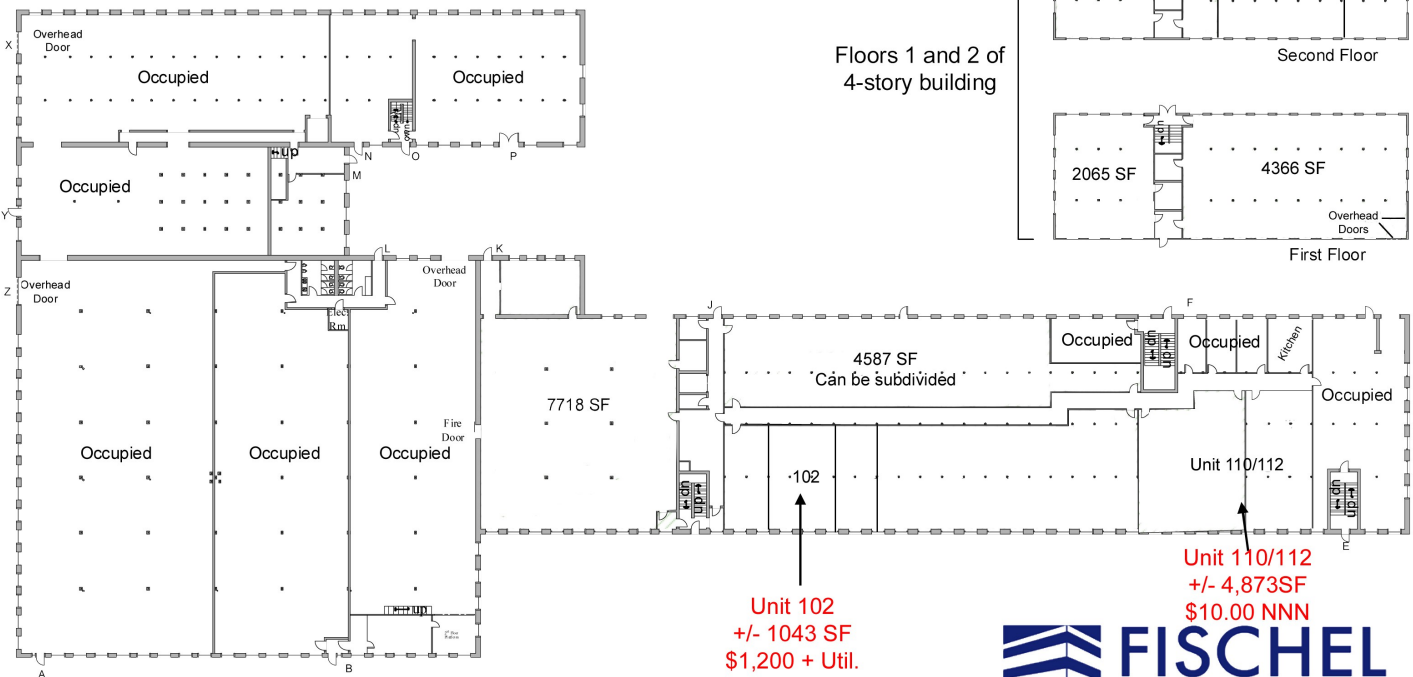

Floors 1 and 2 of  
4-story building

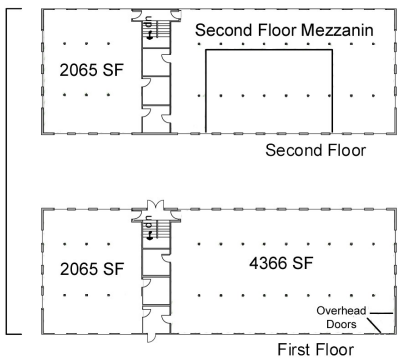

← West Street and  
Downtown New Milford

Boat slips on Housatonic River

Unit 102  
+/- 1043 SF  
\$1,200 + Util.

Unit 110/112  
+/- 4,873SF  
\$10.00 NNN



501 Kings Highway East, Fairfield, CT 06825  
Phone: 203-696-1000 Fax: 203-384-8000  
[www.FischelProperties.com](http://www.FischelProperties.com)



**Mick Consalvo**  
203.241-5188  
mconsalvo@towercorp.com

# The Bleachery

## 143 West Street, New Milford

### Second Floor

Not to Scale

 Available Space

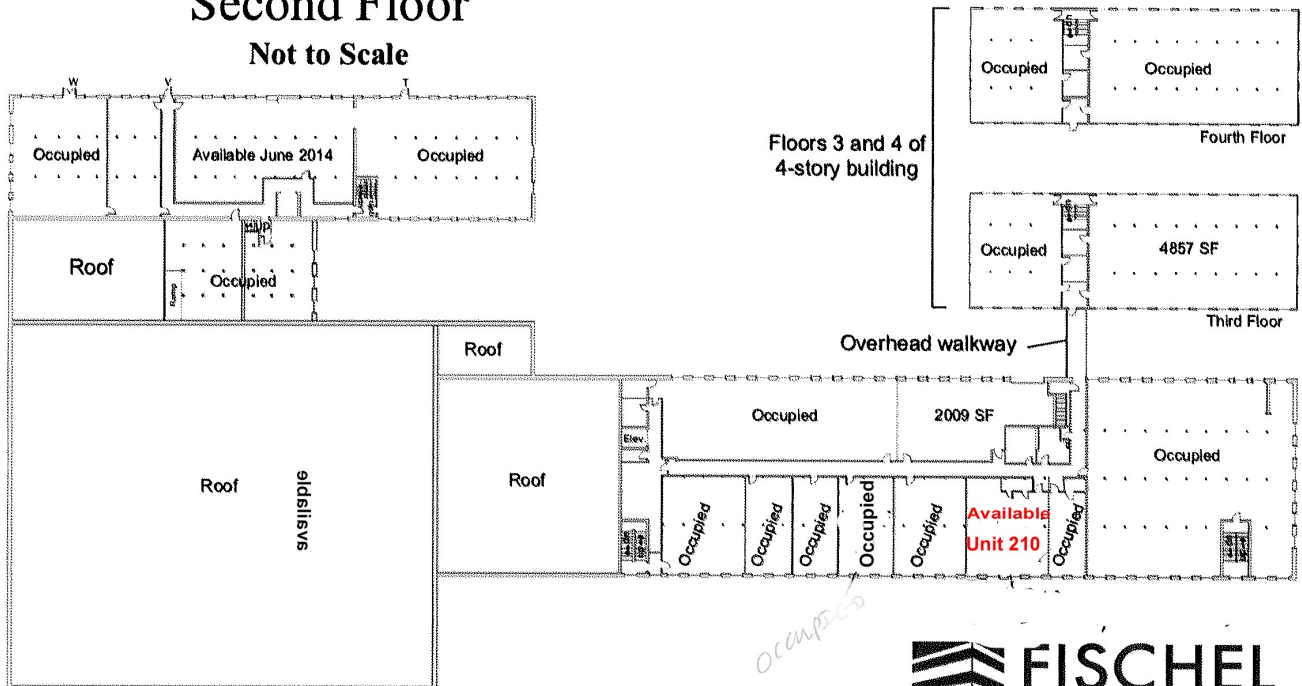

← West Street and  
Downtown New Milford

Boat slips on Housatonic River



501 Kings Highway East, Fairfield, CT 06825  
Phone: 203-696-1000 Fax: 203-384-8000  
[www.FischelProperties.com](http://www.FischelProperties.com)

~ LOCATION MAP ~

30 Shelter Rock Road, Unit 3,  
Danbury, CT



**Mick Consalvo**  
203.241-5188  
mconsalvo@towercorp.com